

# École Père Kenneth Kearns Catholic Elementary School Traffic Management Plan

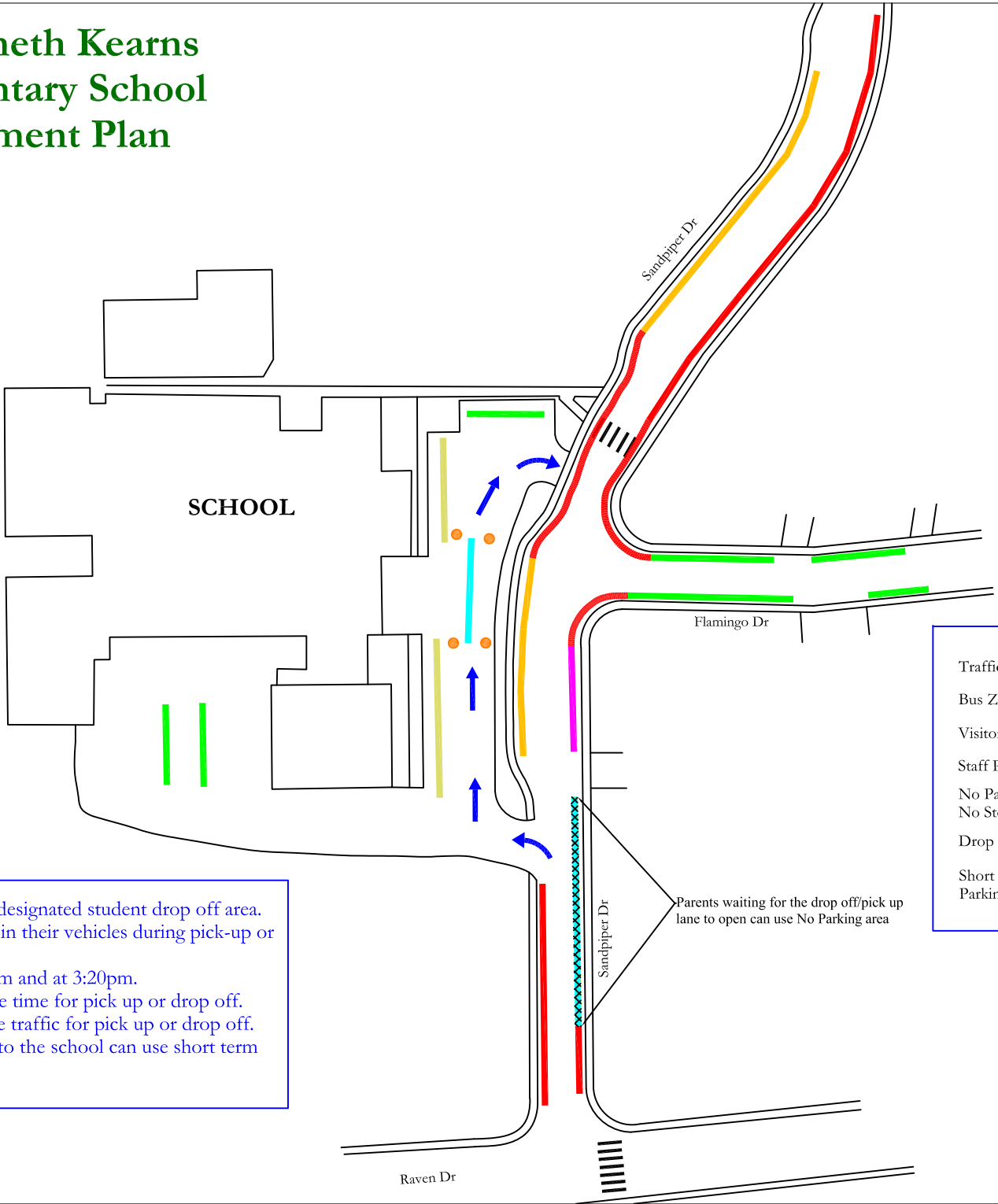

Traffic Flow	
Bus Zone	
Visitor Parking	
Staff Parking	
No Parking/ No Stopping	
Drop off/Pick up Zone	
Short Term (15 min) Parking	

- Parents are requested to use designated student drop off area.
- Parents are requested to stay in their vehicles during pick-up or drop-off.
- Drop off lane opens at 8:30am and at 3:20pm.
- Three vehicles stopped at one time for pick up or drop off.
- Parents should use single lane traffic for pick up or drop off.
- Parents who wish to walk in to the school can use short term parking along Sandpiper Dr.

Parents waiting for the drop off/pick up lane to open can use No Parking area